

JCD543P USB-C™ Triple Display Docking Station with 100W PD Adapter

The USB-C™ Triple Display Docking Station provides extra connectivity from your computer. Extend up to three monitors through **HDMI™**, **VGA**, and **DisplayPort™** or **HDMI™**. This docking station is designed to be used as a notebook stand, which assists with heat dissipation. With its flexible USB-C™ cord, it keeps in mind the location of the USB-C™ port on your device, ensuring an easy connection.

These multi-adapters allow you to add an additional USB™ 3.1/SD™/microSD™ computer peripheral, HDMI™/DisplayPort™/VGA monitor and Gigabit Ethernet through your USB™ port. One of the USB™ Type-A ports supports fast charging BC1.2 for a smartphone, tablet or iPad®. The USB-C™ port supports power delivery 3.0, allowing you to keep charging your notebook or smartphone while using the adapter.

USB-C™ Triple Display Docking Station with 90W PD Adapter JCD543P



Features:

- USB-C™ power delivery 100W pass-through
- USB-C™ downstream port Gen 1 5G x1 ; Power delivery adapter in port x1
- USB™ Type-A downstream port Gen 1 5G x3
- DisplayPort™ Alt mode supported
- DisplayPort™/HDMI™ output 4K @ 30 Hz
- USB™ graphic HDMI™ resolution 4K @ 30 Hz; VGA Resolution 1920 x 1080 dual output
- RJ45 Gigabit Ethernet
- SD™/microSD™ card slots allow for external memory access
- Combo audio jack mic/speaker
- Cable length 1.5 ft/45 cm

Simultaneous DisplayPort™, HDMI™ and VGA Output

Supports Mirror and Extended modes on both Mac® & Windows®
The easiest way to add a second or third display



HDMI™/DisplayPort™/VGA Output Port

Supports 3 Video Interfaces



DisplayPort™ Alt mode for HDMI™ or DisplayPort™ resolution up to 4K @ 30 Hz,
HDMI™ resolution up to 4K @ 30 Hz and VGA resolution up to 1920 x 1080 via dual output

USB-C™ Power Delivery 100W Pass-Through



Charge your notebook or desktop through the JDS43P

SD™/microSD™ Card Reader

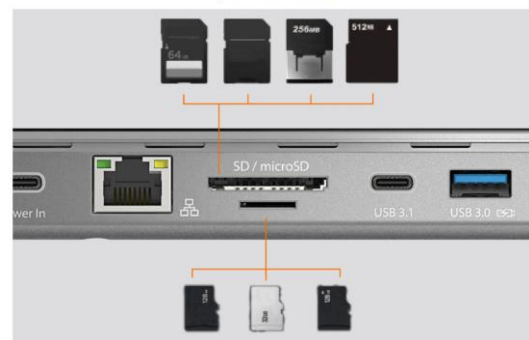

Easily manage and backup your data from your camera, video recorder and more

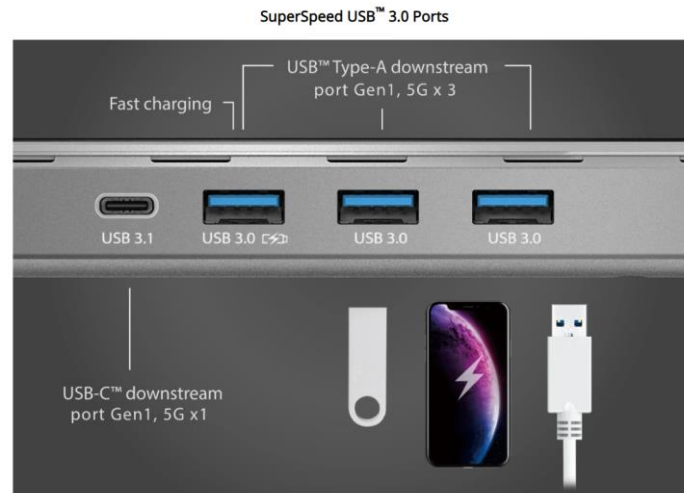

13 Port Types In One Sleek Design For All Your Needs

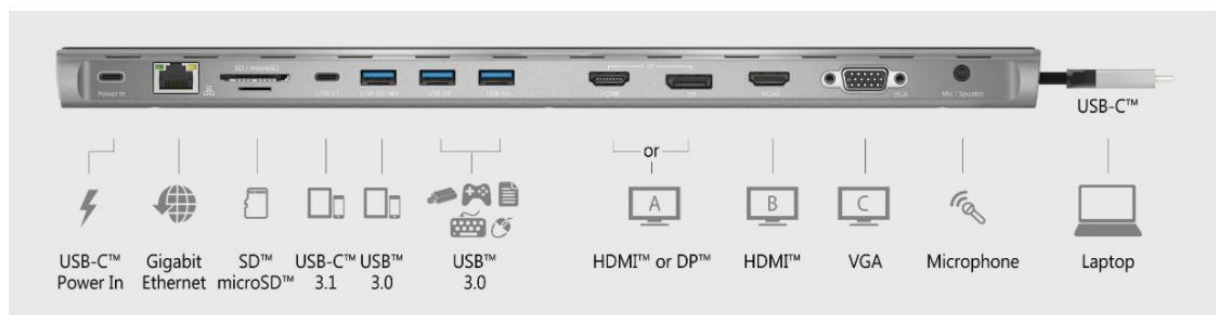

Double Sided Cable Storage Compartment

Place the cable anyway you like



Cutting-Edge Design

The advanced heat-eliminating design makes the JCD543P the perfect solution for expanding any laptop into a full-sized workstation without the worry of overheating.

Cable Storage with Dual Openings

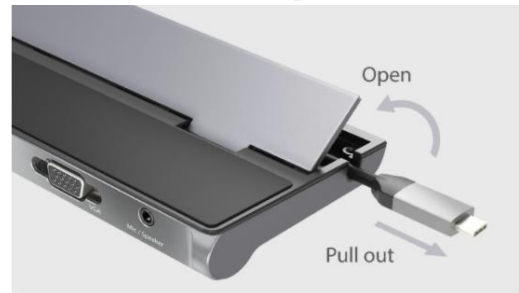

Universal Compatibility

Compatible with both Mac® & Windows®

USB-C™ 90W PD

USB™ Type-A 5V/2A

Power Adapter Included

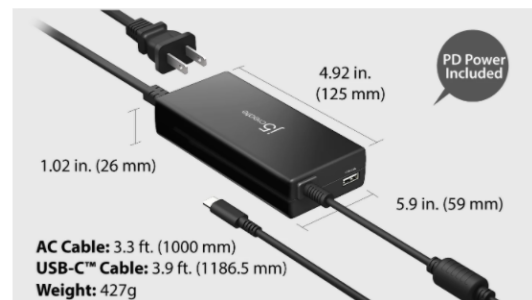

Physical Specifications

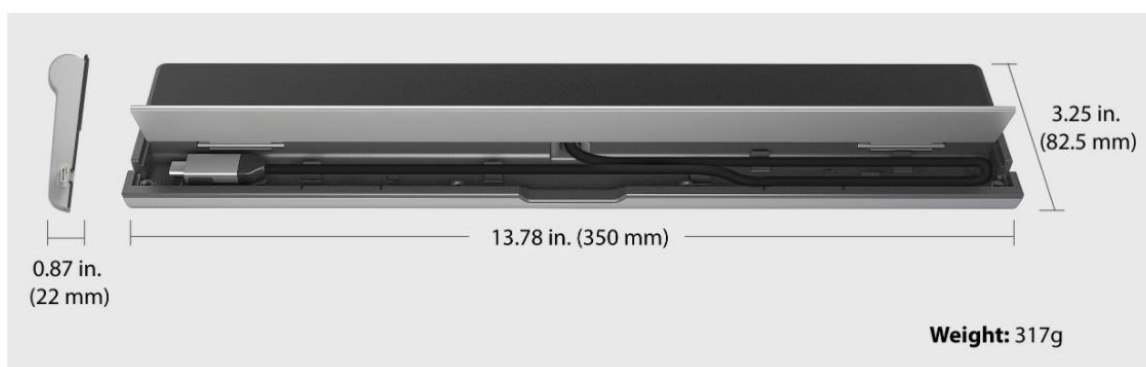

JCD543P Specification

Interface	
Host Interface	USB-C™ male connector with cable
Video Interface	HDMI™ female connector x 2 DisplayPort™ female connector x 1 VGA female connector x 1
USB-C™ Port	USB-C™ downstream port female connector x 1 USB-C™ power in port female connector x1
Ethernet Port	RJ45 female connector (Gigabit Ethernet) x 1
USB™ Port	USB™ Type-A 3.1 5G female connector x 3
Card Slots	SD™ 3.0 x 1 Slot microSD™ 3.0 x 1 Slot
Combo Audio Jack	Microphone and speaker

Power	
Power Mode	Bus-powered or self-powered
Functions	
DisplayPort™ Alt Mode	Display resolution: 4K @ 30 Hz
HDMI™	Display resolution: 4K @ 30 Hz
VGA	Display resolution: 1920 x 1080 @ 60 Hz
USB-C™	Power delivery 3.0 x 1

	USB-C™ 3.1 port x 1
USB™	USB™ Type-A 3.1 port x 3 (USB™ 3.1 Gen 1/5 Gbps) BC 1.2 port x 1
Ethernet	Transfer Rate: 1000 Mbps (Half Duplex)/1000 Mbps (Full Duplex) IEEE: IEEE 802.3az, IEEE 802.3, 802.3u, and 802.3ab, IEEE 802.3x Modes: <ul style="list-style-type: none"> • Supports Wake on LAN function, suspend mode and remote wakeup via link-change, Magic Packet™ or Microsoft® wakeup frame • Supports IEEE 802.1Q VLAN tagging and 2 VLAN ID filtering
Physical Specifications	
Dimensions	Main body: 3.24 (W) x 0.92 (H) x 13.78 (D) in. 82.5 (W) x 23.4 (H) x 350 (D) mm USB-C™ cable length: 1.5 ft/450 mm
Weight	Main body: Approximately: 0.66 lbs./300g

Environmental	
Storage Temperature	-10 – 65°C
Storage Humidity	< 85% non-condensing
Operation Temperature	0 – 40°C
Operation Humidity	< 85% non-condensing

System Requirements

- Available USB-C™ DisplayPort™ Alt mode

- Available USB-C™ port (USB™ 3.0 is recommended)
- Available USB™ power delivery over USB-C™ to support upstream charging
- 4K capable graphics card
- Microsoft® Windows® 10 (32-bit or 64-bit)
- macOS® 10.8 or later

Notes

- If you are using a high-powered USB™ device, attach the USB-C™ power adapter to the power delivery port to ensure maximum performance.
- To ensure files copy completely, do not remove the USB-C™ power adapter while copying files. For maximum performance, use a computer and USB-C™ power adapter equipped with PD 3.0.

Extended Monitor System Requirements

- One 2K (2048 x 1152 @ 60 Hz) full-screen video playback
- CPU: Intel® Core™ i5 Quad Core RAM: 4 GB memory or higher
- Two 2K (2048 x 1152 @ 60 Hz) full-screen video playback
- CPU: Intel® Core™ i7 Quad Core
- RAM: 8 GB memory or higher
- Higher processor recommended for multi-displays and optimal performance.

Package Contents

- USB-C™ Triple Monitor Docking Station
- Quick Installation Guide
- 100W USB-C™ Power Adapter